

FORM NO. 1.

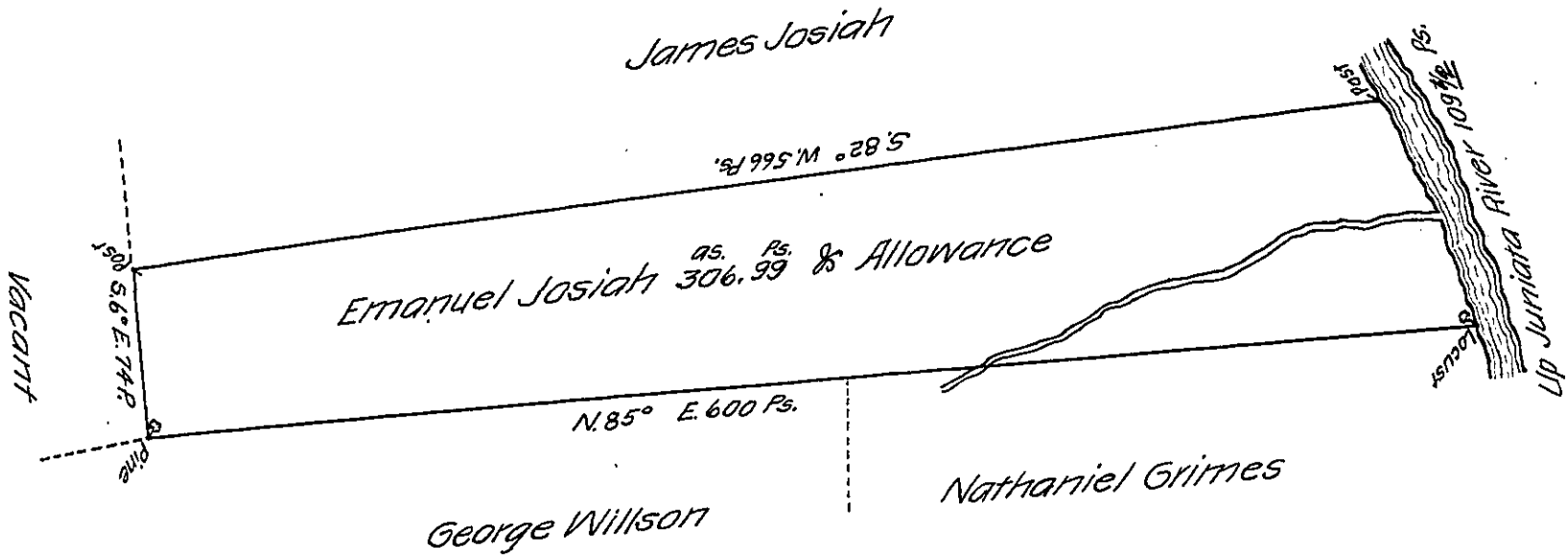

A Draught of a Tract of Land situate in Rye Township in the County of Cumberland Containing three hundred & six Acres and ninety-nine Perches and an allowance of Six & Cent for Roads &c. Survey'd March 18th 1768 for Emanuel Josiah in pursuance of an Order of Survey bearing Date the 27th April 1767. and Numbered 3511.

John Armstrong, D.S.

To John Lukens Esq^r
 Surveyor General }

IN TESTIMONY that the above is a copy of the original remaining on file in the Department of Internal Affairs of Pennsylvania, made conformably to an Act of Assembly approved the 16th day of February 1833, I have hereunto set my hand and caused the Seal of said Department to be affixed at Harrisburg, this fifth day of October, 1907.

Henry Fouche
 Secretary of Internal Affairs.